

# Tate Andale Tank Vent Terminal Valves

These vent terminal valves were designed for use where space for mounting is limited and where installation would be difficult because of limited access. Because of their compact design, these vents provide lower initial cost as well as lower installation costs. TATE Figure Nos. 52-40 (without cover) and 52-45 (with cover) conform to U.S. Coast Guard requirements. The ratio of open area through the flame screen to the inlet pipe area is 1½:1, and the size and weight of the vent terminal are kept to a minimum by TATE's conically designed flame screen. These vents are available in Cast Steel, Semi-Steel, and Bronze.

When ordering parts: Specify size, figure no., and body material.

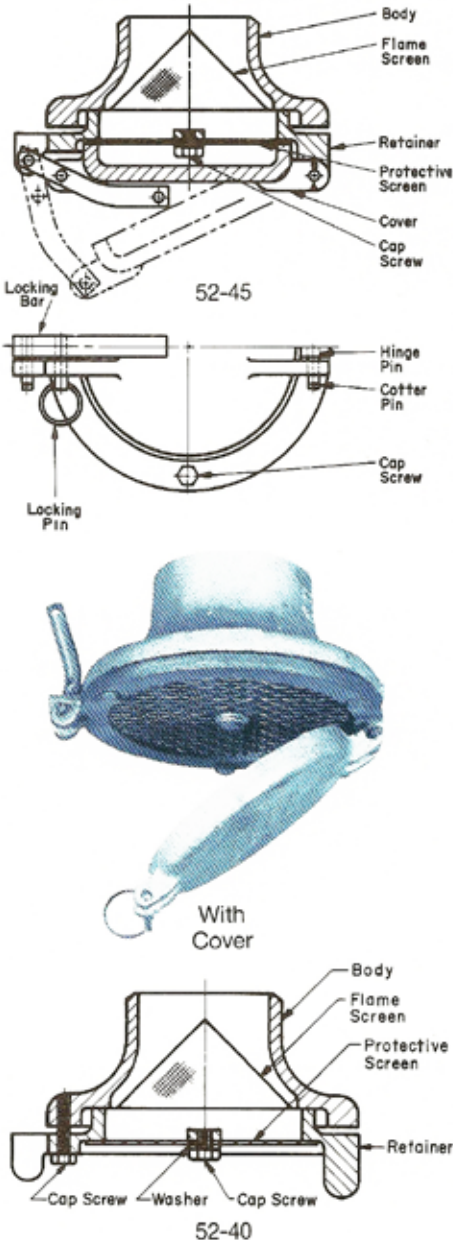

## FLANGED 52-40F

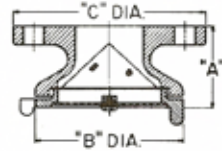

### Reference Dimensions Inches — 52-40F

Size	1 ½	2	2 ½	3	3 ½	4	5	6	8	10	12
A	2 ¾	2 ¾	2 ¾	3 ¼	3 ¾	3 ¾	4 ¼	5 ¾	6 ¾	7 ¾	8 ¾
B	3 ¾	4 ¾	5 ¾	6 ¼	7	7 ¾	9 ½	11	14	17	21 ¾
C	5	6	7	7 ½	8 ½	9	10	11	13 ½	16	19
*WGT	6 ¼	11	12 ½	16 ½	21	25	33 ½	44	70	103	193 ¼

## FLANGED 52-45F

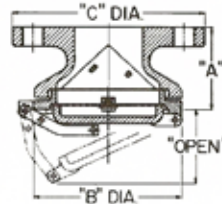

### Reference Dimensions Inches — 52-45F

Size	1 ½	2	2 ½	3	3 ½	4	5	6	8	10	12
A	2 ¾	2 ¾	2 ¾	3 ¼	3 ¾	3 ¾	4 ¼	5 ¾	6 ¾	7 ¾	8 ¾
B	3 ¾	4 ¾	5 ¾	6 ¼	7	7 ¾	9 ½	11	14	17	21 ¾
C	5	6	7	7 ½	8 ½	9	10	11	13 ½	16	19
Open	2 ½	2 ½	2 ½	2 ½	2 ½	2 ½	4 ¾	4 ¾	6 ¾	6 ¾	6 ¾
*WGT	7	12	14	18 ½	23 ½	28	36 ½	49	82	121	219

## BUTT WELDED 52-40V (Steel Only)

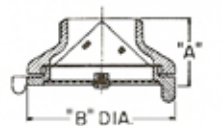

### Reference Dimensions Inches — 52-40V

Size	1 ½	2	2 ½	3	3 ½	4	5	6	8	10	12
A	2 ¾	2 ¾	2 ¾	3 ¼	3 ¾	3 ¾	4 ¼	5 ¾	6 ¾	7 ¾	8 ¾
B	3 ¾	4 ¾	5 ¾	6 ¼	7	7 ¾	9 ½	11	14	17	21 ¾
*WGT	2 ¼	3 ½	5	7	9	9 ½	14	20	34	51 ½	117

## BUTT WELDED 52-45V (Steel Only)

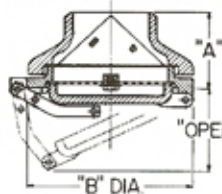

### Reference Dimensions Inches — 52-45V

Size	1 ½	2	2 ½	3	3 ½	4	5	6	8	10	12
A	2 ¾	2 ¾	2 ¾	3 ¼	3 ¾	3 ¾	4 ¼	5 ¾	6 ¾	7 ¾	8 ¾
B	3 ¾	4 ¾	5 ¾	6 ¼	7	7 ¾	9 ½	11	14	17	21 ¾
Open	2 ½	2 ½	2 ½	2 ½	2 ½	2 ½	4 ¾	4 ¾	6 ¾	6 ¾	6 ¾
*WGT	3	6	6 ½	9	11 ½	12 ½	17	25	46	59 ½	143

## IPS THREADED 52-40T



### Reference Dimensions Inches — 52-40T & 52-40TV

Size	1 ½	2	2 ½	3	3 ½	4	5	6	8	10	12
A	2 ¾	2 ¾	2 ¾	3 ¼	3 ¾	3 ¾	4 ¼	5 ¾	6 ¾	7 ¾	8 ¾
1A	4 ¾	4 ¾	4 ¾	5 ¾	5 ¾	5 ½	7	8	10 ¼	11	12
B	3 ¾	4 ¾	5 ¾	6 ¼	7	7 ¾	9 ½	11	14	17	21 ¾
*WGT	3 ½	5	7	8 ½	10 ½	12	17	23	38	56 ½	122

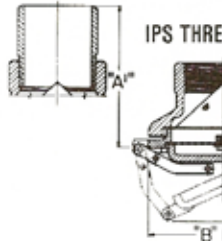

### Reference Dimensions Inches — 52-45T & 52-45TV

Size	1 ½	2	2 ½	3	3 ½	4	5	6	8	10	12
A	2 ¾	2 ¾	2 ¾	3 ¼	3 ¾	3 ¾	4 ¼	5 ¾	6 ¾	7 ¾	8 ¾
1A	4 ¾	4 ¾	4 ¾	5 ¾	5 ¾	5 ½	7	8	10 ¼	11	12
B	3 ¾	4 ¾	5 ¾	6 ¼	7	7 ¾	9 ½	11	14	17	21 ¾
Open	2 ½	2 ½	2 ½	2 ½	2 ½	2 ½	4 ¾	4 ¾	6 ¾	6 ¾	6 ¾
*WGT	4	6	8 ½	10 ½	13	15	20	28	50	64 ½	148

## SIL BRAZED 52-40S

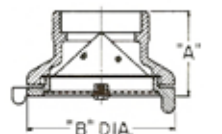

### Reference Dimensions Inches — 52-40S

Size	1 ½	2	2 ½	3	3 ½	4	5	6	8	10	12
A	2 ¾	2 ¾	2 ¾	3 ¼	3 ¾	3 ¾	4 ¼	5 ¾	6 ¾	7 ¾	8 ¾
B	3 ¾	4 ¾	5 ¾	6 ¼	7	7 ¾	9 ½	11	14	17	21 ¾
*WGT	3 ½	5	7	8 ½	10 ½	12	17	23	38	56 ½	122

## SIL BRAZED 52-45S

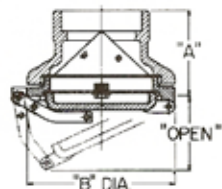

### Reference Dimensions Inches — 52-45S

Size	1 ½	2	2 ½	3	3 ½	4	5	6	8	10	12
A	2 ¾	2 ¾	2 ¾	3 ¼	3 ¾	3 ¾	4 ¼	5 ¾	6 ¾	7 ¾	8 ¾
B	3 ¾	4 ¾	5 ¾	6 ¼	7	7 ¾	9 ½	11	14	17	21 ¾
Open	2 ½	2 ½	2 ½	2 ½	2 ½	2 ½	4 ¾	4 ¾	6 ¾	6 ¾	6 ¾
*WGT	4	6	8 ½	10 ½	13	15	20	28	50	64 ½	148

\*APPROXIMATE